

This document and its design content is copyright ©. It shall be read in conjunction with all other associated project information including models, specifications, schedules and related consultants documents.

Do not scale from this drawing. All dimensions to be checked on site. Immediately report any discrepancies, errors and omissions to the originator. If in doubt ASK.

© Crown copyright [and database rights] 2015 Ordnance Survey 100019994. Re-use of additional photo copies of this map are not permitted except where the end user holds a relevant licence with Ordnance Survey.

Safety Health and Environmental Information Box
 Construction Risks, Maintenance/Cleaning Risks, Demolition/Adaptation Risks:

Drawing Notes

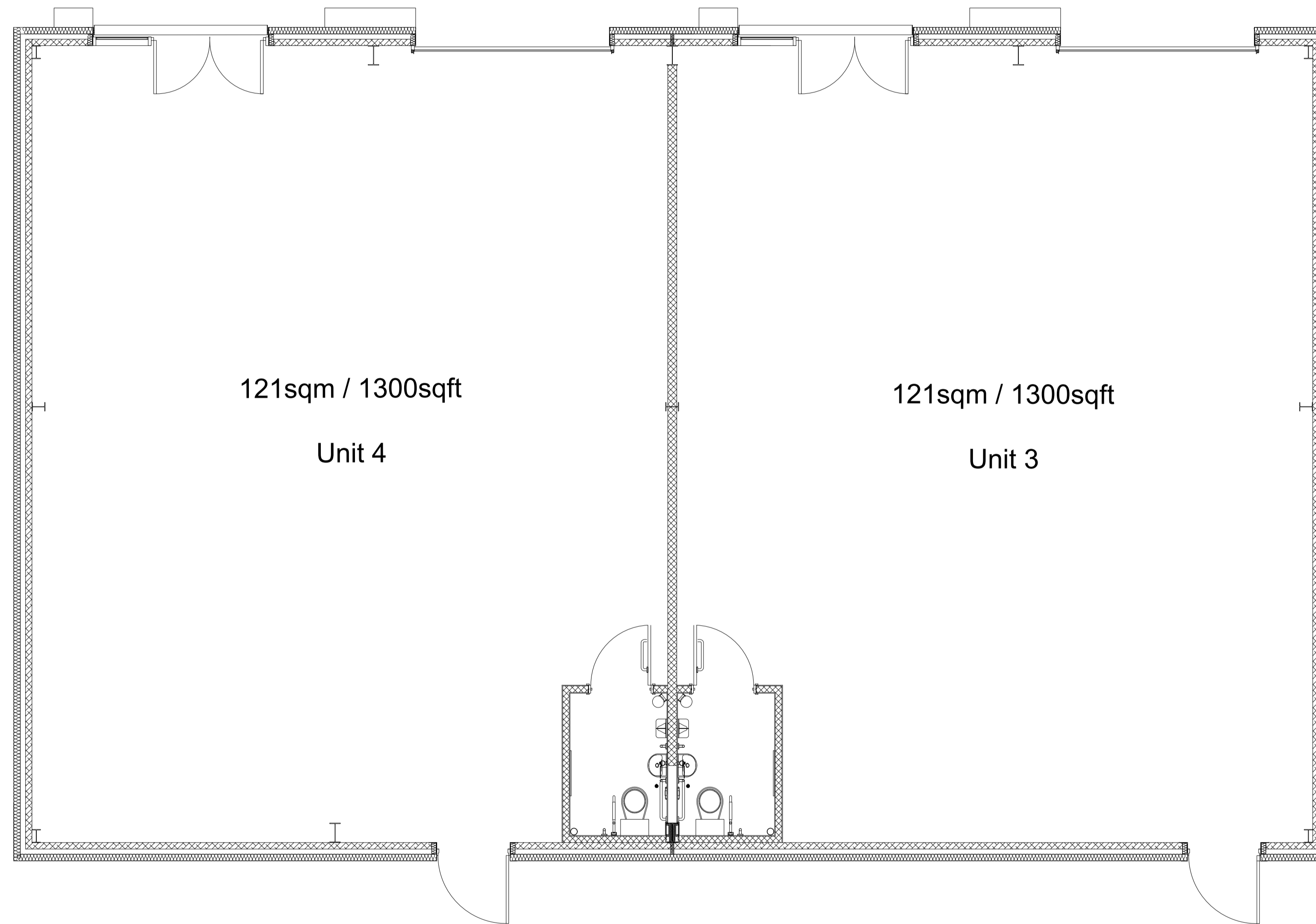

Rev	Description	Drawn By	Date
Rev A	Unit 3 & 4 reduced in size	VB	02/02/2023
Stage	Feasibility		



bit | Borough of Telford & Wrekin Council
 Wellington Civic Offices | Telford PO Box 457
 T: 01827 384 500
 W: www.bit-group.co.uk

Client
**Telford & Wrekin Council
 Estates & Investments**

Project
Stafford Park 11, Telford

Drawing Title
**Proposed Floor Plan
 Unit 3&4**

Drawn VB Checked Date 27/07/2022

Scale 1:50 Sheet Size A1 Drawing Revision REV A

Project	Organised	Zone	Level	Type	Rev.	Number
21333	bit	XX	XX	DR	A	03105